

Montane Andes - 7 Section Table



Features

- 7 section treatment table includes fold down segments in head and chest section
- Electric high/low height adjustment from 49 to 101 cm for easy and safe patient transfer and adjustment to the ideal working height for treatment
- Easy access foot switch, accessible from any position around the table 360°, for simple height adjustment
- Features smooth vertical lift with a capacity up to 150 kg
- Available in 4 casters or 2 wheel versions
- Motorized adjustable middle section with postural drainage model (optional equipment)
- Adjustable head support - positive/negative inclinations
- Face hole on head section with removable cushion
- Side brackets for stabilizing belts are standard equipment

Table Articulations

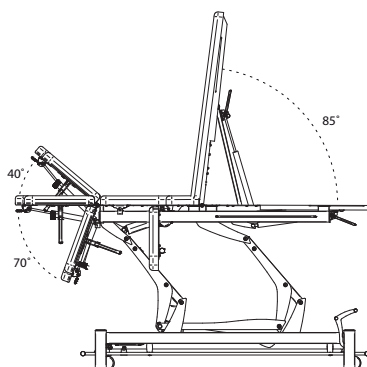
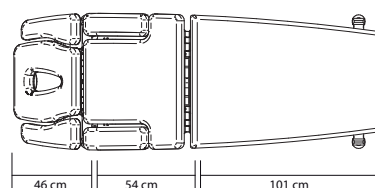
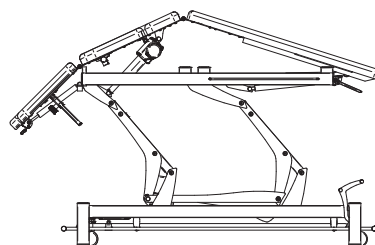

Ordering Information

Part Number Description

Montane Andes

3570	Andes 7 Section 120 V - 2 Wheels / 2 Legs
3571	Andes 7 Section 120 V - 4 Wheels
3572	Andes 7 Section 120 V with Postural Drainage - 2 Wheels / 2 Legs
3573	Andes 7 Section 120 V with Postural Drainage - 4 Wheels
3575	Andes 7 Section 230 V - 2 Wheels / 2 Legs
3576	Andes 7 Section 230 V - 4 Wheels
3577	Andes 7 Section 230 V with Postural Drainage - 2 Wheels / 2 Legs
3578	Andes 7 Section 230 V with Postural Drainage - 4 Wheels

Technical Specifications

Mains Power:	230 V / 50 Hz, 120 V / 60 Hz
Standby Consumption:	3.5 W
Input:	230 V / 1.0 A / 50 Hz, 120 V / 1.9 A / 60 Hz
Weight:	110 kg (242 lbs) plus 30 kg pallet when shipping
Dimensions*:	201 x 69 x 49 - 101 cm
Shipping Dimensions*:	219 x 84 x 75 cm
Lifting Capacity:	150 kg (330 lbs)
Electrical Safety Class:	Class II, Type B
Safety Tests:	Meets Directive 93 / 42 / EEC, Certified to CAN/CSA Standard C22.2 No. 601.1-M90X/A2

* Dimensions are listed as L x W x H

Upholstery Color Options

Ecru-Crème (x = 00)	Beige (x = 01)	Blue (x = 02)
Navy Blue (x = 03)	Terra Cotta (x = 04)	Chocolate (x = 05)
Gray (x = 06)	Graphite Gray (x = 07)	Black (x = 08)

NOTICE: Color charts are produced within the limitations of lithographic color printing and are intended as a general guide only.

For ordering purposes, please use model number, hyphen, upholstery color number as indicated in the chart above.
Example: Montane Andes 7 Postural Drainage in Chocolate - 3578-05